

HORTUS BOTANICUS LEIDEN | THE NETHERLANDS

yearbook Landscape Architecture Europe

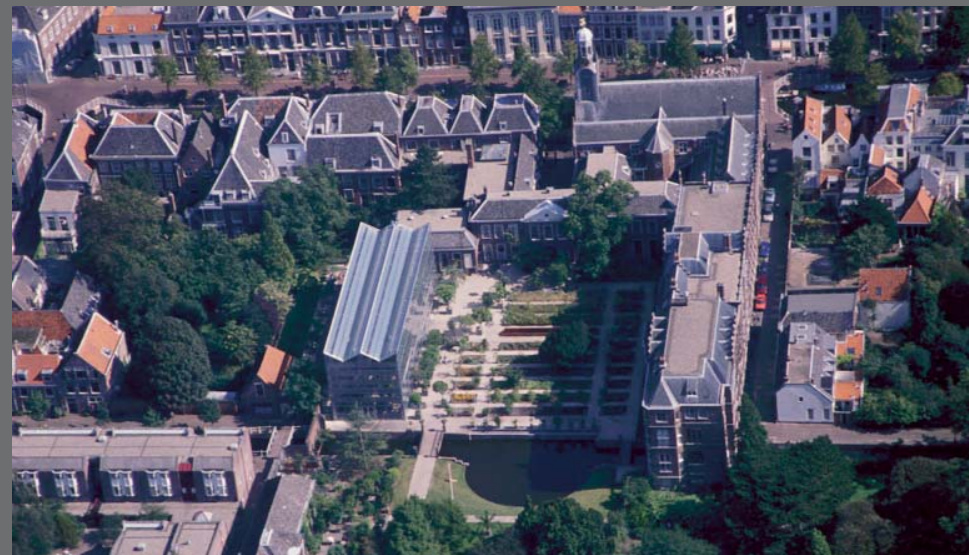

• overall plan



the assignment

As the oldest scientific garden and university research institute within the Netherlands the Hortus Botanicus in Leiden is a unique phenomenon. Due to the cancellation of a number of subsidy schemes, the Hortus, as part of the University of Leiden, is faced with the task of having to operate in a more commercial manner whilst maintaining its scientific objectives. It wants to enhance its worth as a living plants museum. This can be achieved by maintaining, developing and utilizing its collection of scientific plants, strengthening its museological character of the garden and the expansion of its public function. In 1997 MTD Landschapsarchitecten was granted an assignment to prepare a strategic concept and layout plan. In 2000 this was elaborated into a design for the first phase, the Front and Gala Garden. In 2004 new layout plans followed in association with the first phase, the Orangery Square and more recently the new System Garden.

the design

The interventions, which were proposed, encompass three scale levels. The initial strategic commitment was the adding of the Front Garden to the system of the city's public spaces. With this the Hortus would form part of the urban fabric of Leiden and the garden becomes more liveable, like a green oasis in the city. In a natural way, the 5e Binnenvestgracht (canal) marks the transition from a public and free Front Garden to a private and payable Hortus Botanicus. The attraction value of the Hortus was increased thanks to the upgrading of the layout of a number of gardens, Front Garden and Gala Garden in the first phase. The new arrangement of the Front Garden was inspired by the orthogonal system of the original Hortus Publicis, standing here at the end of the 16th century. Trees have been positioned in the plant sections in an apparently haphazard fashion, which subtly differentiates the scale of the adjacent building. Between the plant sections there is a two-sided wooden bench, 16 metres in length, where one has a beautiful view of the botanical garden. Once again the water feature of the 5e Binnenvestgracht has been given an architectural form in the shape of a semi-circular pond. A new building has been introduced in the Front Garden; the Winter Garden. The transparent glasshouse, which is approximately 12 metres high, designed by Hubert-Jan Henket & Partners architects, accommodates the enormous pot plants in winter and the Hortus Café. The Hortus Café gives entrance to the Gala Garden at the other side of the Winter Garden. This garden has been given a museological layout, by a row of columns on which, in the course of time, the over-sized busts of special visitors could be placed.

The second phase, the Orangery Square on the other side of the 5e Binnenvestgracht, has been laid out in cohesion with the Front Garden. Two long stretches of plant beds mark the space where in an orthogonal pattern the pot plants from the Orangery are placed during summer.

The third phase, the new System Garden places the new plant system of DNA- based cladograms next to the historical plant system showed in the Clusius Garden. The layout of plant beds in the grass, emphasises the equal arrangement of the plant families.

The new layout of the Hortus makes the botanic garden a phenomenon that justifies the rich history of the development of this place.



HORTUS BOTANICUS LEIDEN | THE NETHERLANDS

yearbook Landscape Architecture Europe

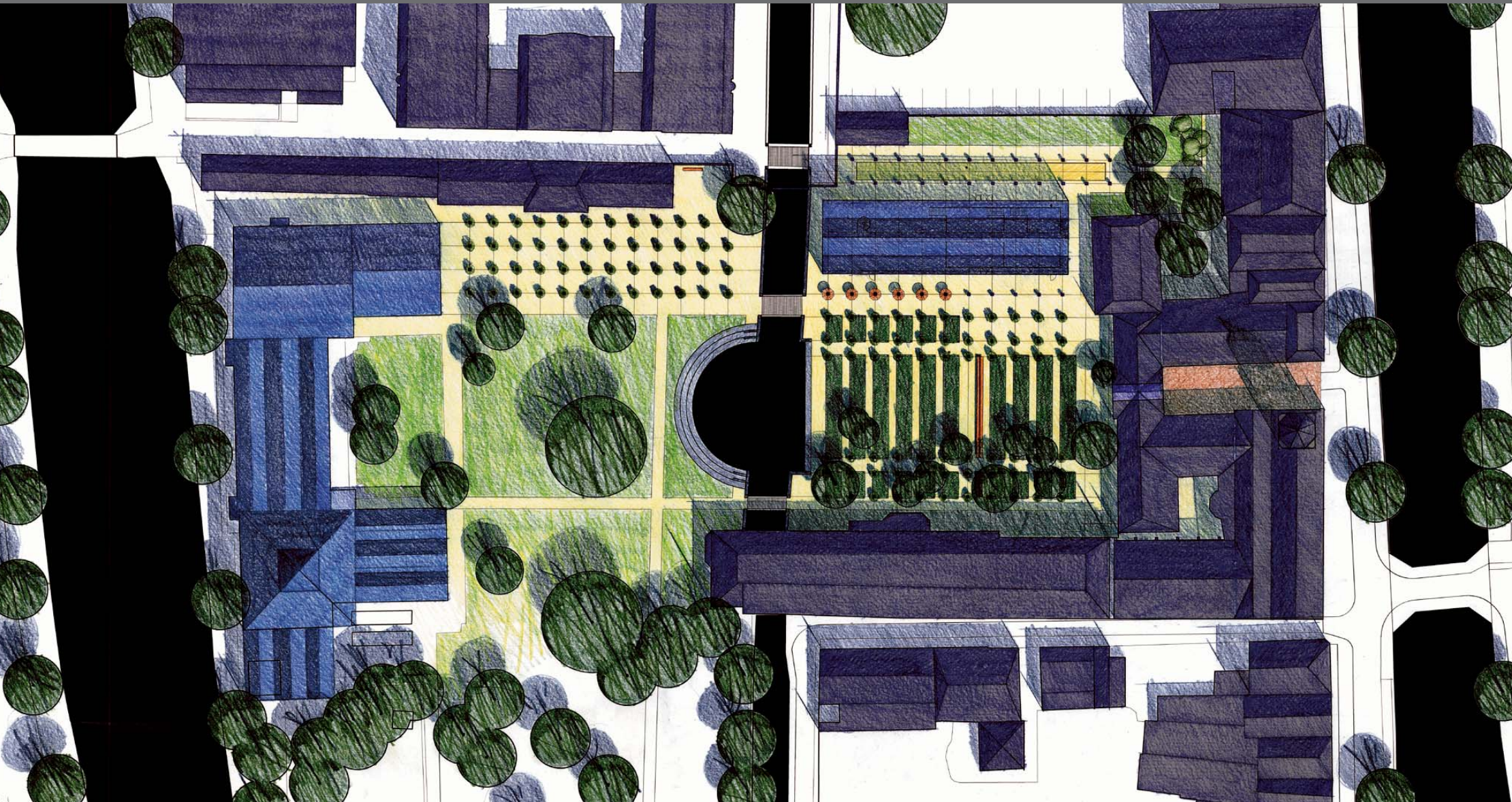

• lay out plan Front Garden



front view | 1/50

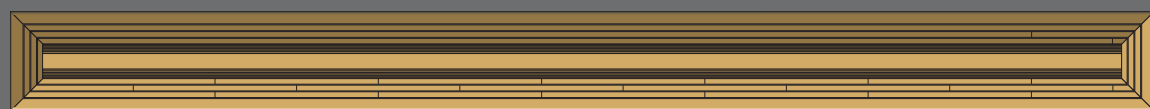

top view | 1/50

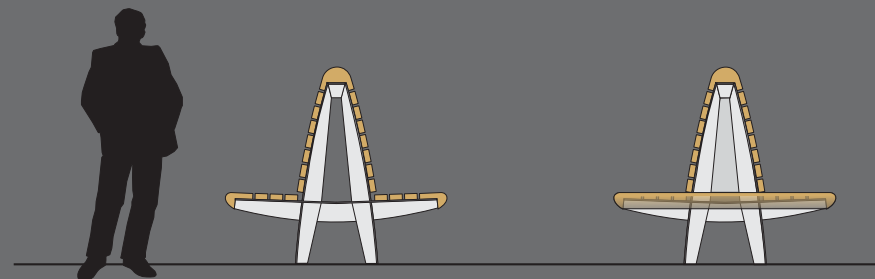

• design wooden bench



HORTUS BOTANICUS LEIDEN | THE NETHERLANDS

yearbook Landscape Architecture Europe

- lay out plan System Garden



- design entrance fence

